

CUSTOMER COPY

REV.	DESCRIPTION	APP.	DATE
A	NEW DESIGN	Amos	2012-07-27

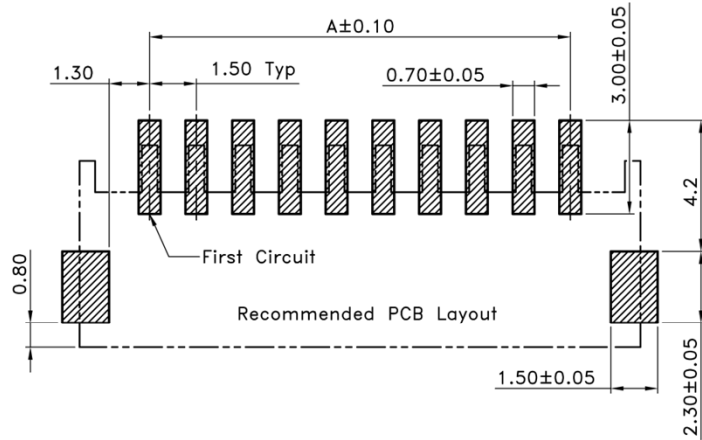
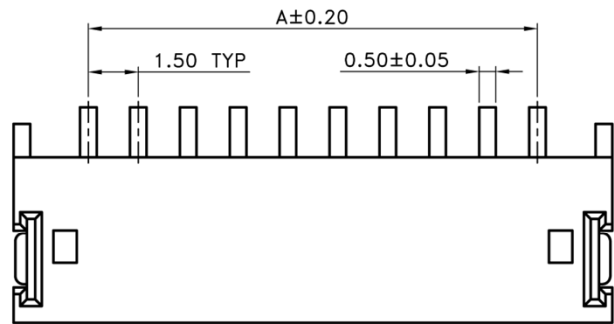

ORDER INFORMATION

1206 5 1 0 XX X

- 1:Plating Tin
- No. of Contact
- 90° SMT
- SH Type

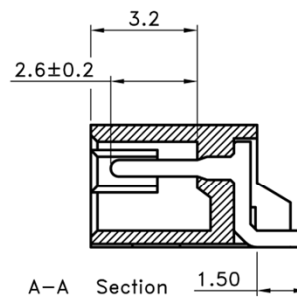
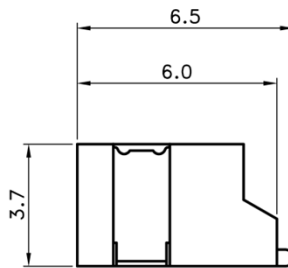
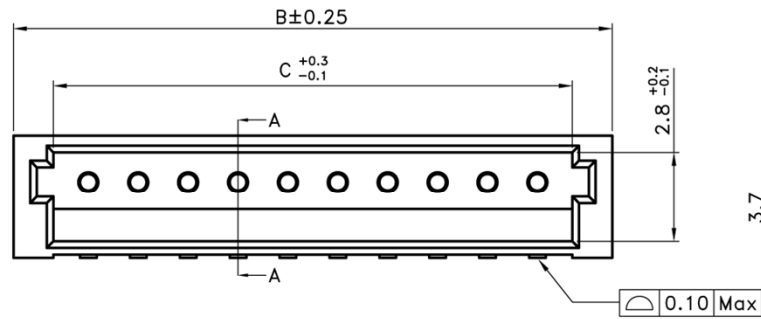

Poles	Dimensions (mm)		
	A	B	C
2	1.50	6.00	3.60
3	3.00	7.50	5.10
4	4.50	9.00	6.60
5	6.00	10.50	8.10
6	7.50	12.00	9.60
7	9.00	13.50	11.10
8	10.50	15.00	12.60
9	12.00	16.50	14.10
10	13.50	18.00	15.60
11	15.00	19.50	17.10
12	16.50	21.00	18.60
13	18.00	22.50	20.10
14	19.50	24.00	21.60
15	21.00	25.50	23.10

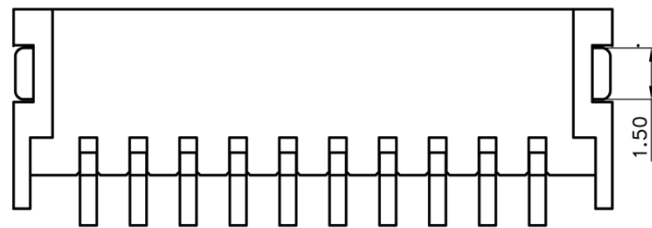

■ SPECIFICATIONS

- Voltage Rating : 50V AC/DC
- Current Rating : 1A AC/DC
- Withstanding Voltage : 500V AC/minute
- Insulation Resistance : 500MΩ min
- Temperature Range : - 25°C to + 85°C
- Contact Resistance : 20mΩ max

■ WAFER

- Poles : 2-15(Right Angle)
- Material : Contact : Brass, Matte-Tin Plated
Base : Nylon 9T UL94V-0
- Q' ty : 1,000 pcs./Tape & Reel



鈺滿榮企業股份有限公司 ACME LUX CO., LTD.

TEL:886-2-85124595

FAX:886-2-85124322

0.0±0.30	SCALE: 1:1	TITLE:	PART NO:
0.00±0.20	UNIT: mm	Pitch 1.5mm Disconnectable Crimp Style Wafer Connector	APP BY: <i>Hung</i>
0.000±0.1		MATL: RoHS	CHK BY: <i>Cheryl</i>
		DWG. NO. C1206510XXX	DR BY: <i>Amos</i>